

OA172EC IP68-ATEX Series

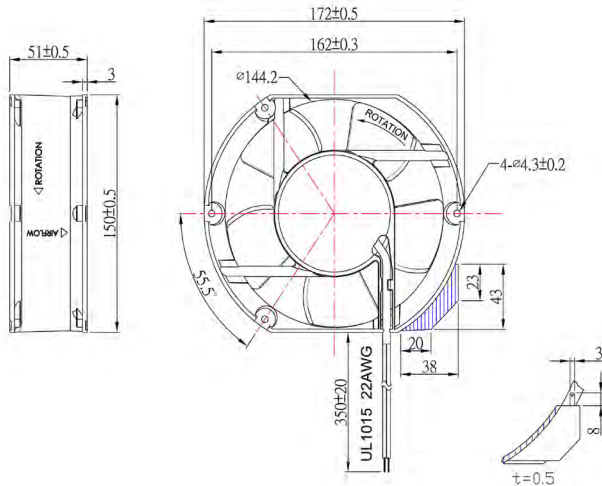

EC Fan - 115V, 230V
172x150x51mm (6.7"x2.0")



Frame	Aluminum (ADC-12)	<u>Operating Temperature</u> Ball Bearing -20C ~ +70C <u>Life Expectancy</u> Ball Bearing 50,000 hours (L10 at 40C) IP68 rating with ATEX Certification
Impeller	PBT, UL94V-O plastic	
Connection	2x Lead wires,(350mm) or Terminals	
Motor	EC Motor, electronically protected	Weight 1.54 lbs m2
Bearing System	Dual ball	
Insulation Resistance	10M ohm between leadwire and frame (500VDC)	
Dielectric Strength	1 sec at 1800 VAC, 50/60Hz	

AIR FLOW (CFM)	115 VAC Static Pressure (inch)	230 VAC Static Pressure (inch)
0	0.62	0.62
50	0.48	0.47
100	0.32	0.31
150	0.22	0.21
200	0.10	0.09
250	0.00	0.00

Model Number	OA172EC-11-1*IP68A	OA172EC-22-1*IP68A
Nominal Voltage	115 VAC (50/60Hz)	230 VAC (50/60Hz)
Voltage Range	103 ~ 127 VAC (50/60Hz)	207 ~ 253 VAC (50/60Hz)
Rated Current	0.23 A	0.13 A
Nominal Power	15 W	15 W
Rated Speed (RPM)	3000	3000
Airflow (CFM)	220	220
Noise Level (dB)	57	57
Max. Static Pressure	0.62" H ₂ O	0.62" H ₂ O

* Indicate "TB" (Terminal Ball Bearing, "WB" (13.78" Wire Leads, Ball Bearing