

5 Port Solenoid Valve Body Ported/Single Unit

SY3000/5000/7000/9000 Series



[Option]

Note) AC-type models that are CE-compliant have DIN terminals only.

How to Order

SY 5 1 20 - 5 L - 01 - - - -

Series	
3	SY3000
5	SY5000
7	SY7000
9	SY9000

Type of actuation

1	2 position single (A) 4 2 (B) (EA) 5 1 3 (EB) (P)
2	2 position double (A) 4 2 (B) (EA) 5 1 3 (EB) (P)
3	3 position closed center (A) 4 2 (B) (EA) 5 1 3 (EB) (P)
4	3 position exhaust center (A) 4 2 (B) (EA) 5 1 3 (EB) (P)
5	3 position pressure center (A) 4 2 (B) (EA) 5 1 3 (EB) (P)

Note) For details about Symbol of the 3 position type of the SY9000 series, refer to page 407.

Coil specifications

Nil	Standard
T	With power saving circuit (24, 12 VDC only)

* Power saving circuit is not available in the case of D, DO, Y, YO or W□ type.

For DC

5	24 VDC
6	12 VDC
V	6 VDC
S	5 VDC
R	3 VDC

Rated voltage

For AC (50/60 Hz)

1	100 VAC
2	200 VAC
3	110 VAC [115 VAC]
4	220 VAC [230 VAC]

* DC specifications of type D, Y, DO and YO is only available with 12 and 24 VDC.
* For type W□, DC voltage is only available.
Note) AC-type models that are CE-compliant have DIN terminals only.

Electrical entry

	24, 12, 6, 5, 3 VDC/100, 110, 200, 220 VAC	24, 12 VDC/100, 110, 200, 220 VAC
Grommet	L plug connector	M plug connector
G: Lead wire length 300 mm	L: With lead wire (Length 300 mm)	M: With lead wire (Length 300 mm)
H: Lead wire length 600 mm	LN: Without lead wire	MN: Without lead wire
	LO: Without connector	MO: Without connector
		DO, YO: Without connector
CE-compliant	DC	AC

24, 12 VDC
6, 5, 3 VDC

M8 connector

WO: Without connector cable

W□: With connector cable

Note)

CE-compliant	DC
	AC

* LN, MN type: with 2 sockets.
* For DIN terminal of SY3000 series, refer to page 639.
* "Y" type is a DIN terminal conforming to EN-175301-803C (former DIN43650C). For details, refer to page 638.
* For connector cable of M8 connector, refer to page 641.
* M8 connector conforming to IEC60947-5-2 standard is also available. Refer to page 623 for details.
* Refer to page 638 for the lead wire length of L and M plug connectors.
* Refer to page 639 for the connector assembly with cover for L and M plug connectors.
Note) Enter the cable length symbols in □. Please be sure to fill in the blank referring to page 642.

Bracket

Nil: Without bracket
F1: With foot bracket

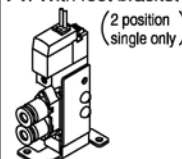

F2: With side bracket

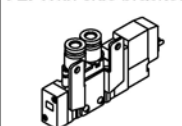

* SY9000 has no bracket.

A, B port size Thread piping

Symbol	Port size	Applicable series
M5	M5 x 0.8	SY3000
01	1/8	SY5000
02	1/4	SY7000
03	3/8	SY9000

One-touch fitting (Metric size)

Symbol	Port size	Applicable series
C4	One-touch fitting for ø4	SY3000
C6	One-touch fitting for ø6	
C4	One-touch fitting for ø4	SY5000
C6	One-touch fitting for ø6	
C8	One-touch fitting for ø8	SY7000
C8	One-touch fitting for ø8	
C10	One-touch fitting for ø10	SY9000
C8	One-touch fitting for ø8	
C10	One-touch fitting for ø10	
C12	One-touch fitting for ø12	

One-touch fitting (Inch size)

Symbol	Port size	Applicable series
N3	One-touch fitting for ø 5/32"	SY3000
N7	One-touch fitting for ø 1/4"	
N3	One-touch fitting for ø 5/32"	SY5000
N7	One-touch fitting for ø 1/4"	
N9	One-touch fitting for ø 3/16"	SY7000
N9	One-touch fitting for ø 3/16"	
N11	One-touch fitting for ø 3/8"	SY9000
N9	One-touch fitting for ø 3/16"	
N11	One-touch fitting for ø 3/8"	

Thread type

Nil	Rc
F	G
N	NPT
T	NPTF

* Except for M5

Made to Order

Nil	—
X20	Body ported external pilot (Refer to page 624.)
X90	Main valve fluoro rubber (Refer to page 624.)

CE-compliant

Nil	—
Q	CE-compliant

Note) AC-type models that are CE-compliant have DIN terminals only.

Manual override

Nil: Non-locking push type



D: Push-turn locking slotted type



E: Push-turn locking lever type



Light/Surge voltage suppressor

Electrical entry for G, H, L, M, W

Nil	Without light/surge voltage suppressor
S	With surge voltage suppressor
Z	With light/surge voltage suppressor
R	With surge voltage suppressor (Non-polar type)
U	With light/surge voltage suppressor (Non-polar type)

* For AC voltage valves there is no "S" option. It is already built-in to the rectifier circuit.
* For "R" and "U", DC voltage is only available.
* Power saving circuit is only available in the "Z" type.

Electrical entry for D, Y

Nil	Without light/surge voltage suppressor
S	With surge voltage suppressor (Non-polar type)
Z	With light/surge voltage suppressor (Non-polar type)

* DOZ and YOZ are not available.
* For AC voltage valves there is no "S" option. It is already built-in to the rectifier circuit.

Note) When placing an order for body ported solenoid valve as a single unit, mounting screw for manifold and gasket are not attached. Order them separately, if necessary. (For details, refer to page 467.)

Body Ported **SY3000/5000/7000/9000 Series**

Specifications

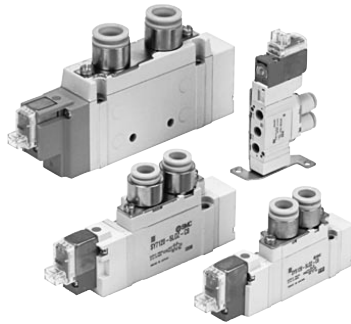

Series		SY3000	SY5000	SY7000	SY9000
Fluid		Air			
Internal pilot Operating pressure range (MPa)	2 position single	0.15 to 0.7			
	2 position double	0.1 to 0.7			
	3 position	0.2 to 0.7			
Ambient and fluid temperature (°C)		-10 to 50 (No freezing)			
Max. operating frequency (Hz)	2 position single, double	10	5	5	5
	3 position	3	3	3	3
Manual override (Manual operation)		Non-locking push type, Push-turn locking slotted type, Push-turn locking lever type			
Pilot exhaust method		Common exhaust type for main and pilot valve			
Lubrication		Not required			
Mounting orientation		Unrestricted			
Impact/Vibration resistance (m/s ²) <small>Note)</small>		150/30			
Enclosure		Dust proof (* DIN terminal and M8 connector: IP65)			

* Based on IEC60529

Note) Impact resistance: No malfunction occurred when it is tested in the axial direction and at the right angles to the main valve and armature in both energized and de-energized states every once for each condition. (Values at the initial period)

Vibration resistance: No malfunction occurred in a one-sweep test between 45 and 2000 Hz. Test was performed at both energized and de-energized states in the axial direction and at the right angles to the main valve and armature. (Values at the initial period)



Made to Order

(For details, refer to pages 616 to 628.)

Solenoid Specifications

Electrical entry			Grommet (G), (H) L plug connector (L) M plug connector (M)	DIN terminal (D), (Y) M8 connector (W)
			G, H, L, M, W	D, Y
Coil rated voltage (V)	DC		24, 12, 6, 5, 3	24, 12
	AC 50/60 Hz		100, 110, 200, 220	
Allowable voltage fluctuation			±10% of rated voltage *	
Power consumption (W)	DC	Standard	0.35 (With indicator light: 0.4 DIN terminal with indicator light: 0.45)	
		With power saving circuit	0.1 (With indicator light only) * [Starting 0.4, Holding 0.1]	
Apparent power (VA) *	AC	100 V	0.78 (With indicator light: 0.81)	0.78 (With indicator light: 0.87)
		110 V	0.86 (With indicator light: 0.89)	0.86 (With indicator light: 0.97)
		[115 V]	[0.94 (With indicator light: 0.97)]	[0.94 (With indicator light: 1.07)]
		200 V	1.18 (With indicator light: 1.22)	1.15 (With indicator light: 1.30)
		220 V [230 V]	1.30 (With indicator light: 1.34) [1.42 (With indicator light: 1.46)]	1.27 (With indicator light: 1.46) [1.39 (With indicator light: 1.60)]
Surge voltage suppressor			Diode (Varistor is for DIN terminal and Non-polar type.)	
Indicator light			LED (AC of DIN connector is neon light.)	

* In common between 110 VAC and 115 VAC, and between 220 VAC and 230 VAC.

* For 115 VAC and 230 VAC, the allowable voltage is -15% to +5% of rated voltage.

* DIN terminal and M8 connector with power saving circuit are not available.

* For details, refer to page 636.

Response Time

Note) Based on dynamic performance test, JIS B 8419: 2010. (Coil temperature: 20°C, at rated voltage)

SY3000

Type of actuation	Response time (ms) (at the pressure of 0.5 MPa)		
	Without light/surge voltage suppressor	With light/surge voltage suppressor	
		Type S, Z	Type R, U
2 position single	12 or less	15 or less	12 or less
2 position double	10 or less	13 or less	10 or less
3 position	15 or less	20 or less	16 or less

SY5000

Type of actuation	Response time (ms) (at the pressure of 0.5 MPa)		
	Without light/surge voltage suppressor	With light/surge voltage suppressor	
		Type S, Z	Type R, U
2 position single	19 or less	26 or less	19 or less
2 position double	18 or less	22 or less	18 or less
3 position	32 or less	38 or less	32 or less

SY7000

Type of actuation	Response time (ms) (at the pressure of 0.5 MPa)		
	Without light/surge voltage suppressor	With light/surge voltage suppressor	
		Type S, Z	Type R, U
2 position single	31 or less	38 or less	33 or less
2 position double	27 or less	30 or less	28 or less
3 position	50 or less	56 or less	50 or less

SY9000

Type of actuation	Response time (ms) (at the pressure of 0.5 MPa)		
	Without light/surge voltage suppressor	With light/surge voltage suppressor	
		Type S, Z	Type R, U
2 position single	35 or less	41 or less	35 or less
2 position double	35 or less	41 or less	35 or less
3 position	62 or less	64 or less	62 or less

SY3000/5000/7000/9000 Series

Flow Rate Characteristics/Weight

SY3000 series

Valve model	Type of actuation	Port size		Flow rate characteristics						Weight (g)			
		1, 5, 3 (P, EA, EB)	4, 2 (A, B)	1→4/2 (P→A/B)		4/2→5/3 (A/B→EA/EB)		Gro-mmet		L/M plug connector	DIN terminal	W M8 connector	
				C (dm ³ /s bar)	b	Cv	b	Cv					
SY3□20 -□-M5	2 position	Single Double Closed center Exhaust center Pressure center	M5 x 0.8	0.61	0.44	0.16	0.64	0.45	0.18	51	53	57	
	3 position			0.48	0.46	0.13	0.47	0.43	0.13	68	74	82	
	3 position			0.47	0.42	0.13	0.47 (0.44)	0.41 (0.37)	0.13 (0.12)	71	76	84	
	3 position			0.50 (0.41)	0.48 (0.35)	0.15 (0.11)	0.47	0.43	0.13				
	3 position			0.72	0.29	0.18	0.64	0.34	0.17	60	63	67	
SY3□20 -□-C4	2 position	Single Double Closed center Exhaust center Pressure center	M5 x 0.8	0.59	0.28	0.15	0.59	0.30	0.15	78	83	91	
	3 position			0.63	0.35	0.16	0.42 (0.41)	0.34 (0.37)	0.11 (0.11)	81	86	94	
	3 position			0.76 (0.46)	0.42 (0.34)	0.21 (0.12)	0.59	0.29	0.15				
	3 position			0.76	0.30	0.19	0.65	0.39	0.17	56	59	63	
	3 position			0.76	0.55	0.24	0.60	0.33	0.16	74	79	87	
SY3□20 -□-C6	2 position	Single Double Closed center Exhaust center Pressure center	M5 x 0.8	0.65	0.32	0.16	0.64 (0.42)	0.31 (0.36)	0.17 (0.11)	77	82	90	
	3 position			0.77 (0.49)	0.34 (0.43)	0.21 (0.15)	0.61	0.34	0.16				
	3 position			0.76	0.30	0.19	0.65	0.39	0.17	56	59	63	
	3 position			0.76	0.55	0.24	0.60	0.33	0.16	74	79	87	
	3 position			0.65	0.32	0.16	0.64 (0.42)	0.31 (0.36)	0.17 (0.11)	77	82	90	

Note) []: denotes normal position.

SY7000 series

Valve model	Type of actuation	Port size		Flow rate characteristics						Weight (g)			
		1, 5, 3 (P, EA, EB)	4, 2 (A, B)	1→4/2 (P→A/B)		4/2→5/3 (A/B→EA/EB)		Gro-mmet		L/M plug connector	DIN terminal	W M8 connector	
				C (dm ³ /s bar)	b	Cv	b	Cv					
SY7□20 -□-02	2 position	Single Double Closed center Exhaust center Pressure center	1/4	4.1	0.23	0.93	3.3	0.33	0.81	101	104	125	108
	3 position			2.9	0.31	0.70	2.4	0.38	0.63	120	125	167	133
	3 position			2.5	0.39	0.65	3.4 (2.1)	0.35 (0.38)	0.82 (0.54)	128	133	175	141
	3 position			4.3 (2.4)	0.23 (0.32)	0.97 (0.61)	2.2	0.39	0.58				
	3 position			3.2	0.26	0.77	3.2	0.37	0.82	107	110	131	114
SY7□20 -□-C8	2 position	Single Double Closed center Exhaust center Pressure center	1/4	2.6	0.24	0.63	2.4	0.31	0.62	126	132	174	140
	3 position			2.4	0.25	0.57	2.6 (1.9)	0.42 (0.46)	0.70 (0.56)	134	140	182	148
	3 position			3.3 (2.4)	0.28 (0.22)	0.78 (0.57)	2.2	0.34	0.60				
	3 position			3.8	0.26	0.86	3.2	0.34	0.82	103	105	126	109
	3 position			2.8	0.27	0.67	2.4	0.21	0.59	122	127	169	135
SY7□20 -□-C10	2 position	Single Double Closed center Exhaust center Pressure center	1/4	2.5	0.25	0.59	2.7 (2.0)	0.38 (0.38)	0.70 (0.56)	130	135	177	143
	3 position			3.8 (2.4)	0.25 (0.31)	0.89 (0.61)	2.3	0.38	0.61				
	3 position			3.8	0.26	0.86	3.2	0.34	0.82	103	105	126	109
	3 position			2.8	0.27	0.67	2.4	0.21	0.59	122	127	169	135
	3 position			2.5	0.25	0.59	2.7 (2.0)	0.38 (0.38)	0.70 (0.56)	130	135	177	143

Note) []: denotes normal position.

SY5000 series

Valve model	Type of actuation	Port size		Flow rate characteristics						Weight (g)			
		1, 5, 3 (P, EA, EB)	4, 2 (A, B)	1→4/2 (P→A/B)		4/2→5/3 (A/B→EA/EB)		Gro-mmet		L/M plug connector	DIN terminal	W M8 connector	
				C (dm ³ /s bar)	b	Cv	b	Cv					
SY5□20 -□-01	2 position	Single Double Closed center Exhaust center Pressure center	1/8	1.9	0.35	0.49	2.4	0.39	0.61	70	72	93	76
	3 position			1.7	0.43	0.45	1.8	0.35	0.46	88	93	135	101
	3 position			1.5	0.44	0.41	2.5 (1.5)	0.32 (0.43)	0.59 (0.40)	93	98	140	106
	3 position			2.2 (0.91)	0.46 (0.58)	0.61 (0.28)	1.8	0.38	0.46				
	3 position			0.75	0.43	0.20	0.85	0.64	0.30	94	96	117	100
SY5□20 -□-C4	2 position	Single Double Closed center Exhaust center Pressure center	1/8	0.74	0.40	0.19	0.84	0.57	0.28	111	117	159	125
	3 position			0.75	0.36	0.19	0.84 (0.84)	0.64 (0.53)	0.30 (0.27)	117	122	164	130
	3 position			0.78 (0.71)	0.44 (0.37)	0.21 (0.16)	0.84	0.57	0.27				
	3 position			1.5	0.33	0.33	2.0	0.37	0.52	88	91	112	95
	3 position			1.3	0.31	0.33	1.6	0.32	0.39	106	111	153	119
SY5□20 -□-C6	2 position	Single Double Closed center Exhaust center Pressure center	1/8	1.3	0.33	0.33	1.8 (1.4)	0.35 (0.37)	0.44 (0.36)	111	116	158	124
	3 position			1.7 (0.80)	0.31 (0.47)	0.42 (0.23)	1.7	0.33	0.44				
	3 position			1.9	0.21	0.45	2.3	0.29	0.57	80	82	103	86
	3 position			1.6	0.29	0.39	1.7	0.38	0.46	98	103	145	111
	3 position			1.4	0.38	0.39	2.0 (1.5)	0.37 (0.41)	0.52 (0.43)	103	108	150	116
SY5□20 -□-C8	2 position	Single Double Closed center Exhaust center Pressure center	1/8	2.2 (1.6)	0.32 (0.44)	0.56 (0.44)	1.8	0.41	0.50				
	3 position			1.6	0.29	0.39	1.7	0.38	0.46	98	103	145	111
	3 position			1.4	0.38	0.39	2.0 (1.5)	0.37 (0.41)	0.52 (0.43)	103	108	150	116
	3 position			2.2 (1.6)	0.32 (0.44)	0.56 (0.44)	1.8	0.41	0.50				
	3 position			1.6	0.29	0.39	1.7	0.38	0.46	98	103	145	111

Note) []: denotes normal position.

SY9000 series

Valve model	Type of actuation	Port size		Flow rate characteristics						Weight (g)			
		1, 5, 3 (P, EA, EB)	4, 2 (A, B)	1→4/2 (P→A/B)		4/2→5/3 (A/B→EA/EB)		Gro-mmet		L/M plug connector	DIN terminal	W M8 connector	
				C (dm ³ /s bar)	b	Cv	b	Cv					
SY9□20 -□-02	2 position	Single Double Closed center Exhaust center Pressure center	1/4	7.0	0.33	1.7	7.6	0.35	2.0	241	244	265	248
	3 position			6.7	0.37	1.7	6.4	0.34	1.6	260	266	308	274
	3 position			6.4	0.36	1.6	8.3 (4.1)	0.41 (0.27)	2.2 (0.91)	284	290	332	298
	3 position			8.0 (3.2)	0.27 (0.34)	1.8 (0.76)	6.5	0.22	1.4				
	3 position			8.0	0.29	1.9	8.0	0.33	2.0	236	239	260	243
SY9□20 -□-03	2 position	Single Double Closed center Exhaust center Pressure center	3/8	7.9	0.33	1.9	6.6	0.27	1.6	255	261	303	269
	3 position			8.0	0.33	1.9	8.7 (8.3)	0.34 (0.40)	2.2 (2.3)	279	285	327	293
	3 position			8.9 (3.3)	0.34 (0.40)	1.9 (0.82)	6.5	0.25	1.5				
	3 position			4.3	0.28	0.96	7.1	0.32	1.7	293	296	317	300
	3 position			4.3	0.31	0.99	6.1	0.28	1.4	312	318	360	326
SY9□20 -□-C8	2 position	Single Double Closed center Exhaust center Pressure center	1/4	4.3	0.31	0.99	6.1	0.28	1.4	336	342	384	350
	3 position			4.3	0.3	0.99	7.4 (3.8)	0.36 (0.29)	1.9 (0.86)				
	3 position			4.4 (3.2)	0.35 (0.26)	1.0 (0.71)	2.1	0.41	0.53				
	3 position			6.1	0.28	1.4	7.9	0.33	1.9	279	282	303	286
	3 position			5.9	0.30	1.4	6.5	0.26	1.5	298	304	346	312
SY9□20 -□-C10	2 position	Single Double Closed center Exhaust center Pressure center	1/4	5.8	0.25	1.3	8.4 (4.1)	0.33 (0.27)	2.0 (0.93)	322	328	370	336
	3 position			6.3 (3.2)	0.29 (0.29)	1.5 (0.72)	6.4	0.25	1.5				
	3 position			7.0	0.25	1.6	8.6	0.41	2.2	265	268	289	272
	3 position			6.9	0.24	1.6	7.0	0.33	1.7	284	290	332	298
	3 position			6.6	0.23	1.4	9.4 (4.5)	0.48 (0.32)	2.6 (1.0)	308	314	356	322
SY9□20 -□-C12	2 position	Single Double Closed center Exhaust center Pressure center	1/4	7.4 (3.2)	0.25 (0.34)	1.7 (0.74)	6.6	0.23	1.5				
	3 position			7.0	0.25	1.6	8.6	0.41	2.2	265	268	289	272
	3 position			6.9	0.24	1.6	7.0	0.33	1.7	284	290	332	298
	3 position			6.6	0.23	1.4	9.4 (4.5)	0.48 (0.32)	2.6 (1.0)	308	314	356	322
	3 position			7.4 (3.2)	0.25 (0.34)	1.7 (0.74)	6.6	0.23	1.5				

Note) []: denotes normal position.

SJ
SY
SY
S0700
S0700

Construction

SY series

Symbol 2 position single

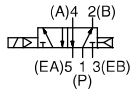

Symbol 2 position double

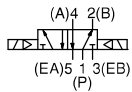

2 position single

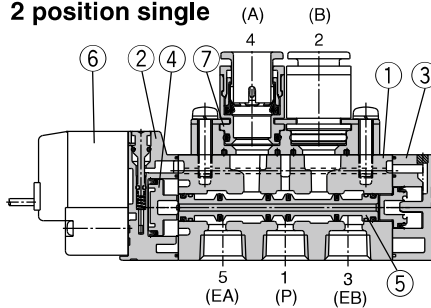

2 position double

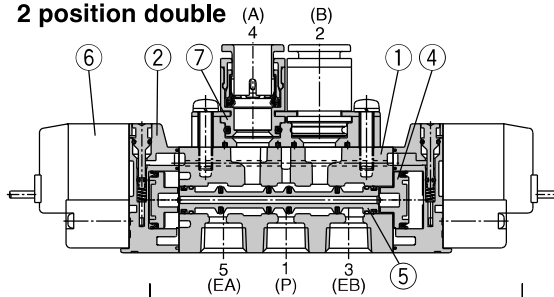

3 position closed center / exhaust center / pressure center

Symbol 3 position closed center

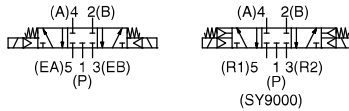

3 position exhaust center

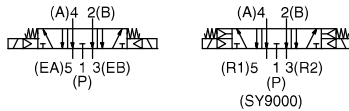

3 position pressure center

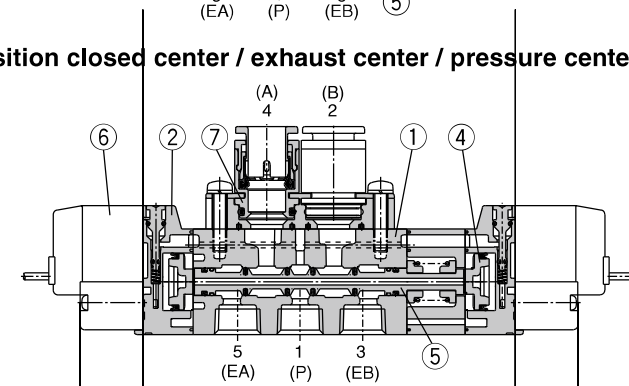

(This figure shows a closed center type.)

Component Parts

No.	Description	Material	Note
1	Body	Aluminum die-casted (SY3000: Zinc die-casted)	White
2	Adapter plate	Resin	White (SY9000: Gray)
3	End plate	Resin	White
4	Piston	Resin	—
5	Spool valve assembly	Aluminum, H-NBR	—

Replacement Parts

No.	Description	Part no.
6	Pilot valve assembly	Refer to "How to Order Pilot Valve Assembly" on page 629.
7	M5 port block assembly	Refer to "How to Order Port Block Assembly" on page 629.

Bracket Assembly No.

Description	Part no.
Bracket (For F1)	SX ³ 000-16-2A (with mounting screw)
Bracket (For F2)	SX ³ 000-16-1A (with mounting screw)

* SY9000 has no bracket.

How to Change Port Block Assembly

If using body port type, both A and E port sizes can be changed by replacing the port block assembly mounted on the body. When changing this block assembly, the correct screw torque must be achieved to avoid possible air leakage.

For SY5000

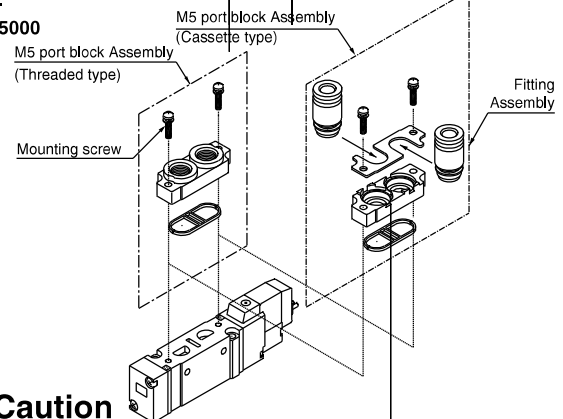

Caution

Mounting screw tightening torques

SY3000 (M2): 0.12 N·m
SY³000 (M3): 0.6 N·m
SY9000 (M4): 1.4 N·m

* Refer to "How to Order Port Block Assembly" on page 629 for part no.

SY3000/5000/7000/9000 Series

Dimensions: SY3000 Series

[]: AC

2 position single

Grommet (G), (H): SY3120-□_G □□-^{C4, N3}_{C6 N7}(-F2)

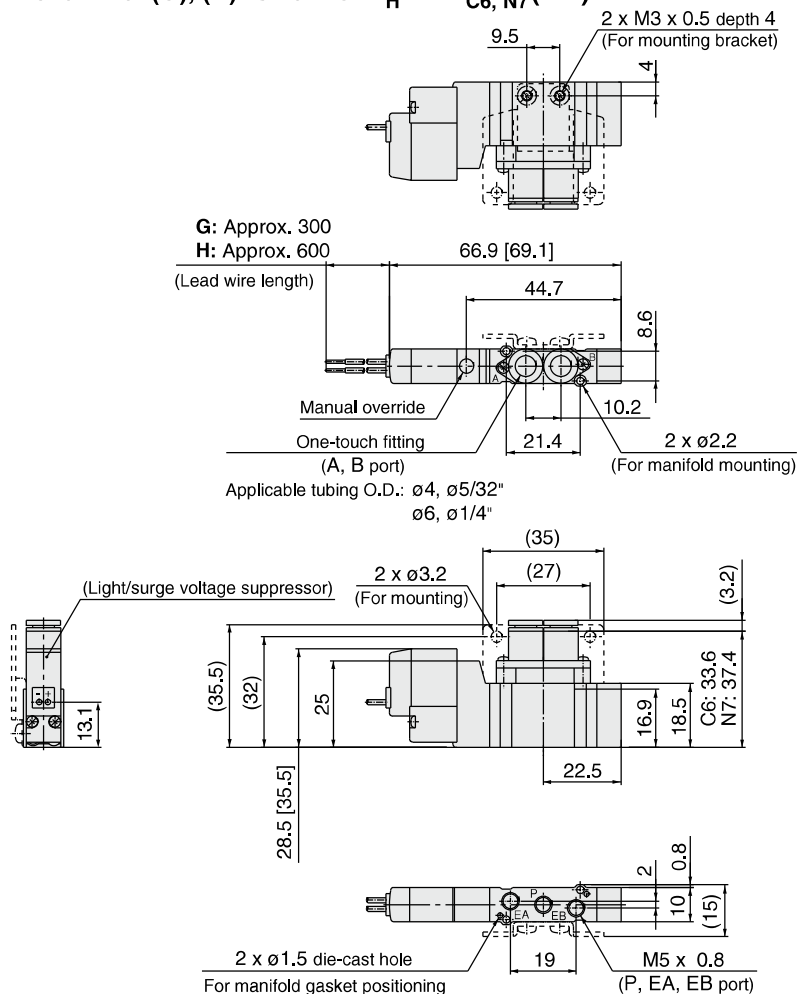

Foot bracket

SY3120- G - C4, N3 -F1
 H - C6, N7

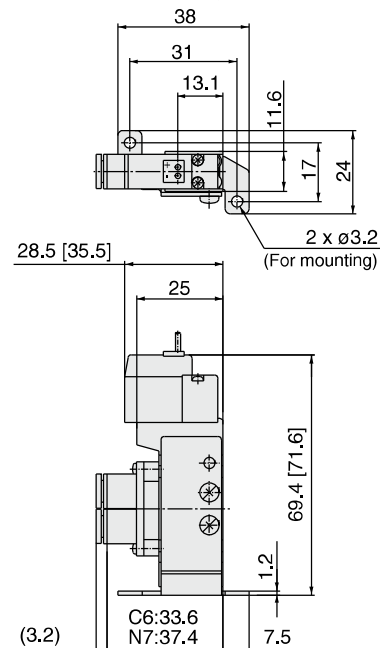
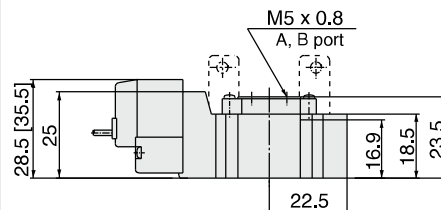
SY3120- $\square_{\text{H}}^{\text{G}}\square\square$ -M5(-F2)

L plug connector (L):

SY3120-□L□□- $\begin{matrix} C4, N3 \\ C6, N7 \end{matrix} (-F_2^1)$

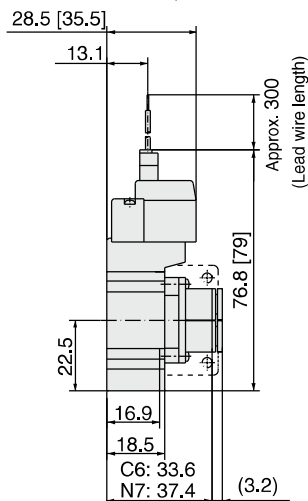

M plug connector (M):

SY3120-□M□□- $\begin{smallmatrix} \text{C}_4, \text{N}_3 \\ \text{C}_6, \text{N}_7 \end{smallmatrix}(-\text{F}_2^1)$

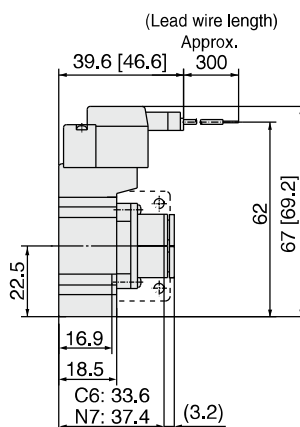

M8 connector (WO):

SY3120-□WO□□- $\begin{smallmatrix} C_4, N_3 \\ C_6, N_7 \end{smallmatrix}(-F_2^1)$

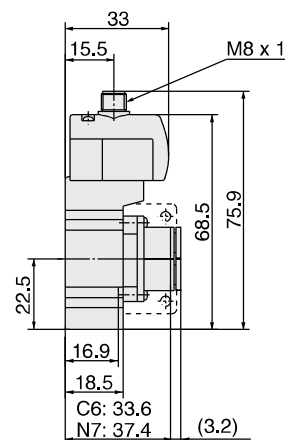

Note) Refer to page 642 for dimensions of connector types.

Body Ported **SY3000/5000/7000/9000 Series**

Dimensions: SY3000 Series

[]: AC

2 position double

Grommet (G), (H): SY3220-□^G□□-C₄, N₃
C₆, N₇(-F2)

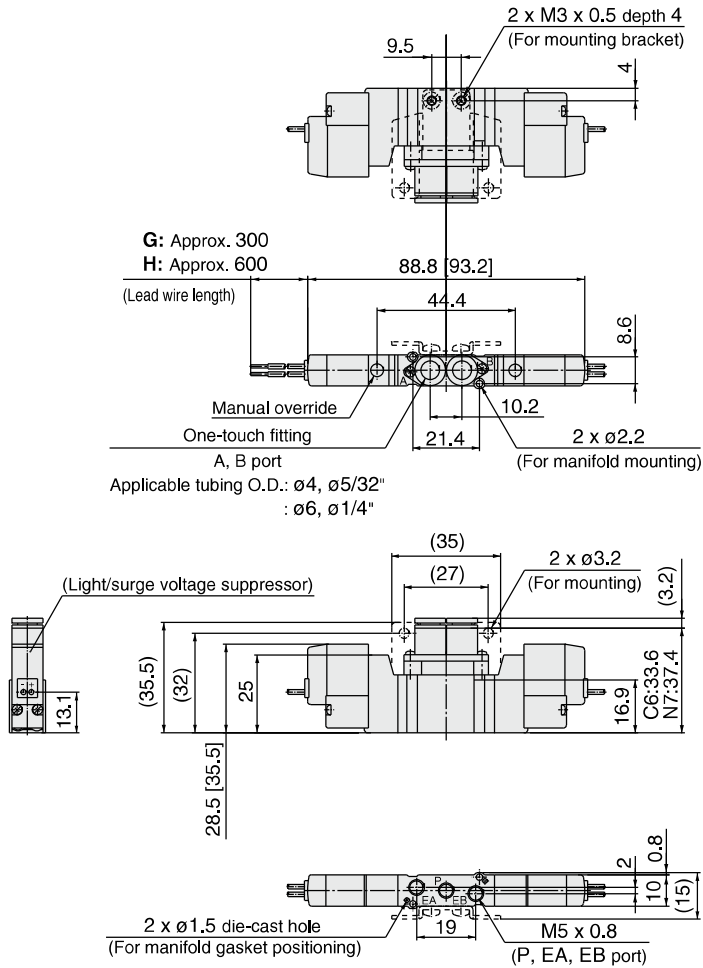

SY3220-□^G□□-M5(-F2)

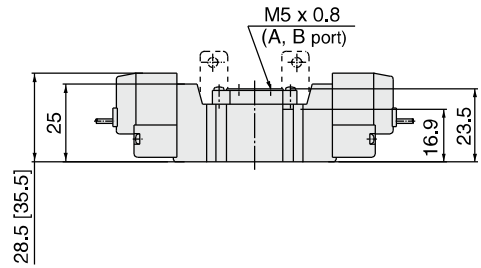

SJ

SY

SY

S0700

S0700

L plug connector (L):

SY3220-□L□□-C₄, N₃
C₆, N₇(-F2)

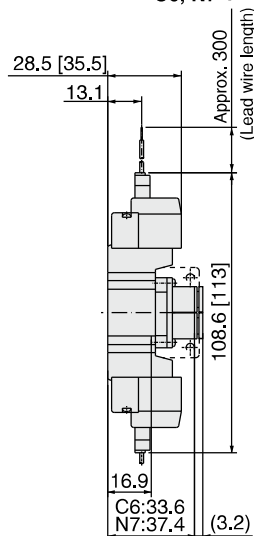

M plug connector (M):

SY3220-□M□□-C₄, N₃
C₆, N₇(-F2)

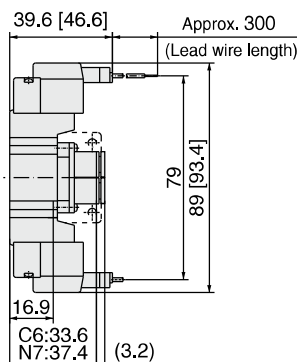

M8 connector (WO):

SY3220-WO□□-C₄, N₃
C₆, N₇(-F₂¹)

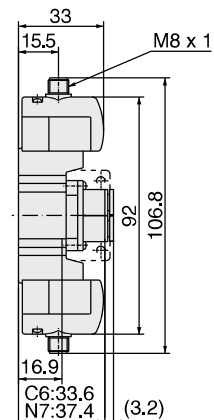

Note) Refer to page 642 for dimensions of connector types.